

PERMIT
 CITY OF NAPOLEON, OHIO - BUILDING DEPARTMENT
 255 West Riverview Avenue, Napoleon, Ohio 43545 - (419) 592-4010

Permit No. 3032 Issued 9-27-93
 Job Location 1155 Westchester 1026 Kenilworth
 Lot 16 Gerken/Hocffel 2nd
 Issued by Brent N. Damman
 Owner April McNeill 599-1943
 Address 1026 Kenilworth, Napoleon, OH
 Agent Mock/Buehrer 592-0825
 Address 1227 Dodd, Napoleon, Ohio
 Use Type - Residential xx
 Other - Describe _____
 No. Dwelling Units 1
 New xx Replacement _____
 Add'n. _____ Alter _____ Remodel _____
 Mixed Occupancy _____
 Change of Occupancy _____
 Estimated Cost \$ 70,000.00

FEES	BASE	PLUS	TOTAL
<input checked="" type="checkbox"/> Building	\$ 9.00	\$ 168.00	\$ 177.00
<input checked="" type="checkbox"/> Electrical	\$ 15.00	\$ 75.00	\$ 90.00
<input checked="" type="checkbox"/> Plumbing	\$ 9.00	\$ 33.00	\$ 42.00
<input checked="" type="checkbox"/> Mechanical	\$ 18.00	\$ 2.00	\$ 20.00
<input type="checkbox"/> Demolition	\$	\$	\$
<input type="checkbox"/> Zoning	\$	\$	\$
<input type="checkbox"/> Sign	\$	\$	\$
<input checked="" type="checkbox"/> Water Tap	\$ 650.00	\$	\$ 650.00
<input type="checkbox"/> Sew. Insp.	\$	\$	\$
<input checked="" type="checkbox"/> Sewer Tap	\$ 60.00	\$	\$ 60.00
<input checked="" type="checkbox"/> Temp. Water	\$ 5.00	\$	\$ 5.00
<input checked="" type="checkbox"/> Temp. Elec.	\$ 10.00	\$	\$ 10.00
TOTAL FEES.....			\$1054.00
LESS FEES PAID.....			\$
BALANCE DUE.....			\$1054.00

ZONING INFORMATION

district	lot dimensions	area	front yd	side yd	rear yd
A	85 x 120	31,440	30'	10'	15'
max hgt	no pkg spaces	no ldg spaces	max cover	petition or appeal req'd	date appr
35'	2 per		35%		

WORK INFORMATION

Size: Length 56' Width 44' Stories 1 Ground Floor Area 1496 s.f.
 Height 14' Building Volume (for Demo. Permit) _____
 Garage Floor Area = 491 s.f. Porch = 80 s.f.
 Electrical: _____
 Plumbing: _____
 Mechanical: _____
 Additional Information: New Home
 Date 9-27-93 Applicant Signature Brent N. Damman

PAID
OCT 12 1993
 CITY OF NAPOLEON

INSPECTION RECORD

	UNDERGROUND			ROUGH-IN					FINAL			
	Type	Date	By	Type	Date	By	Type	Date	By	Type	Date	By
PLUMBING	Building Drains			Drainage, Waste & Vent Piping	1/17	BD	Indirect Waste			Drainage, Waste & Vent Piping		
	Water Piping	10/12	BD							Backflow Prevention		
	Building Sewer	10/12	BD	Water Piping	1/17	BD	Condensate Lines			Water Heater		
	Sewer Connection	10/12	BD							FINAL APPROVAL	10	BD
MECHANICAL	Refrigerant Piping			Refrigerant Piping			Chimney(s)			Grease Exhaust System		
				Duct Furnace(s)	1/17	BD	Fire Dampers			Air Cond. Unit(s)		
	Ducts/Plenums			Ducts/Plenums	1/17	BD	<input type="checkbox"/> Radiant Htr(s) <input type="checkbox"/> Unit Htr(s)			Refrigeration Equipment		
				Duct Insulation	1/17	BD	Pool Heater			Furnace(s)		
				Combustion Products Vents			Ventilation <input type="checkbox"/> Supply <input type="checkbox"/> Exhst.			FINAL APPROVAL	10	BD
ELECTRICAL	Conduits & or Cable			Conduits/ Cable	1/17	BD	<input type="checkbox"/> Range <input type="checkbox"/> Dryer			Temp Service Temp Lighting		
	Grounding & or Bonding			Rough Wiring	1/17	BD	<input type="checkbox"/> Generator(s) <input type="checkbox"/> Motors			Fixtures Lampholders		
	Floor Ducts Raceways			Service Panel Switchboard			<input type="checkbox"/> Water Htr <input type="checkbox"/> Welder			Signs		
	Service Conduit			Busways Ducts			<input type="checkbox"/> Heaters <input type="checkbox"/> Heat Cable			Electric Mtr. Clearance		
	Temporary Power Pole			Subpanels			<input type="checkbox"/> Duct Htr(s) <input type="checkbox"/> Furnace(s)			FINAL APPROVAL		
BUILDING	Location, Set-backs, Esmt(s)			Exterior Wall Construction	1/17	BD	Roof Covering Roof Drainage	1/17	BD	Smoke Detector		
	Excavation	10/12	BD				Exterior Lath	1/17	BD	Demolition (sewer cap)		
	Footings & Reinforcing	10/12	BD				<input type="checkbox"/> Interior Lath <input type="checkbox"/> Wallboard	12/1	BD			
	Floor Slab			Interior Wall Construction	1/17	BD	Fire Wall(s)			Building or Structure	10	BD
	Foundation Walls			Columns & Supports			Fireplace Chimney					
	Sub-soil Drain			Crawl Space <input type="checkbox"/> Vent <input type="checkbox"/> Access	1/17	BD	Attic <input type="checkbox"/> Vent <input type="checkbox"/> Access					
	Piles			Floor System(s)	1/17	BD				FINAL APPROVAL BLDG. DEPT.	10	BD
				Roof System	1/17	BD	Special Insp Reports Rec'd			Certificate of Occupancy Issued	11/14	BD
ADDITIONAL	INSPECTIONS, CORRECTIONS, ETC.						INSPECTIONS, CORRECTIONS, ETC.					
	Service panel only											
	100 amp not approved. 1/16 BD											
Service changed to												
200 amp O.K.												

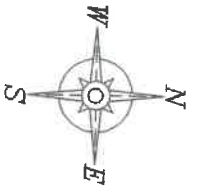

BRIARHEATH

WESTCHESTER

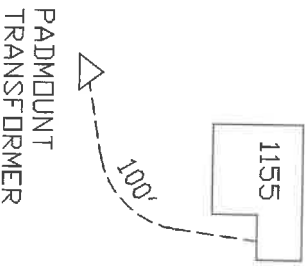

INSTALL A 4/0
UNDERGROUND SERVICE

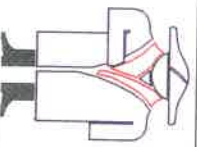

Napoleon Power & Light

<i>1775 Industrial Drive Napoleon, Ohio</i>			
ITEM	1155 WESTCHESTER AVE		
DATE	W.O.#	J.O.#	DRAWN BY
11/30/93	32404	JO1283	MTD

WATER TAPPING PERMIT

issued by

The Napoleon Water Distribution Department

255 West Riverview Ave. Napoleon, Ohio 43545 Ph. 592-4010

Permit No. W- 0173 Issued 10/13/93 Received of Keith Bucher (\$ ~~100~~) .00

(Charge for tapping permit to supply water service to) Lot No. 16 Sub Div. Gerken/Hoffel 2nd

Street No. 1155 Westchester Tap Size 1 Cost \$ 650 .00 Plumber Mark Bucher

Date completed _____ Approved by _____
water distribution dept. finance director

Name _____ Size of tap 1" Date 11/5/93 Street and No. 1155 Westchester

Old Tap No. _____ New Tap No. 9373 Size and Kind of Main 6" AC

Location of Main 10' South of South curb Depth of Main 4 1/2'

Distance from Hydrant/Valve 131' W of Hyd 402 Distance to Curb Stop from Corp. 8'

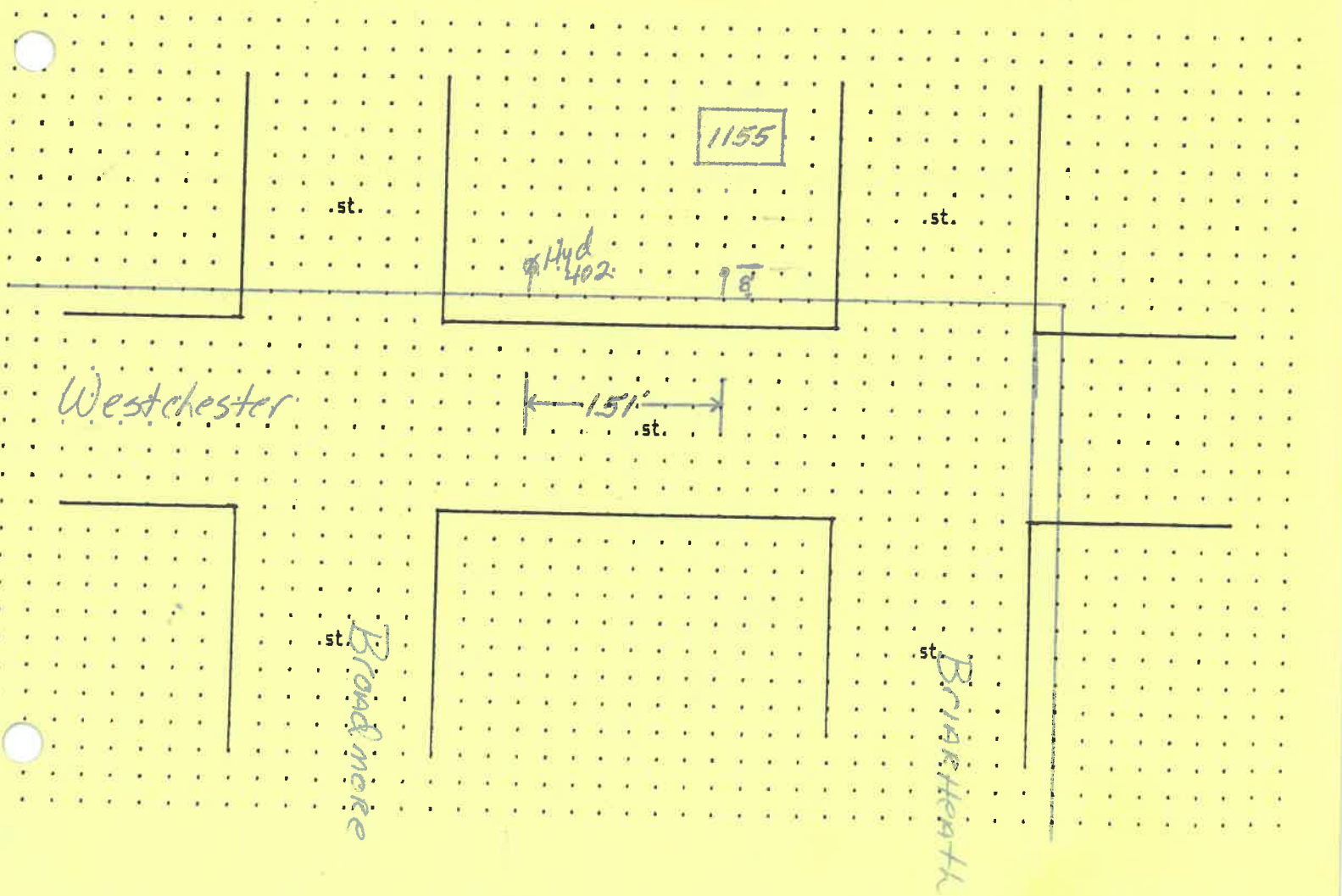

10-6-93
 Burkholder Const.
 April McNeil
 1155 Westchester

